

51.2V 314AH LV LITHIUM BATTERY

Lithium iron phosphate battery system is a standard battery system unit, customers can choose a certain number of lithium battery according to their needs, by connecting parallel to form a larger capacity battery pack, to meet the user's long-term power supply needs. The product is especially suitable for energy storage applications with high operating temperatures, limited installation space, long power backup time and long service life.

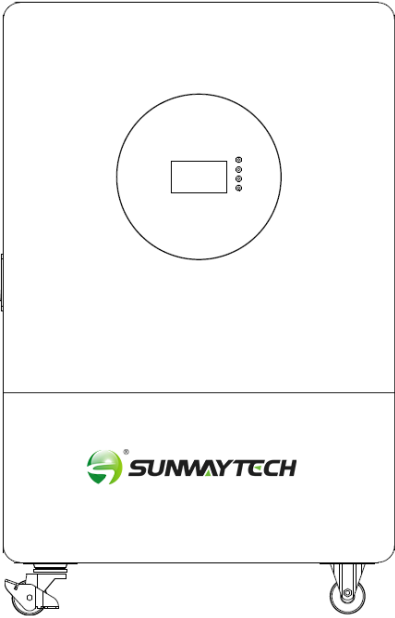

★ MAIN FEATURES

- The whole module is non-toxic, non-polluting and environmentally friendly
- With BlueTooth function which cell phone shift BMS protocol freely
- Battery management system with better performance, possesses protection function like over-discharge, over-charge, over-current, abnormal temperature
- Self-management on charging and discharging, Single core balancing function.
- Intelligent design configures integrated inspection module
- Flexible configurations allow parallel of multi battery for longer standby time
- Less battery self-discharge, then recharging period can be up to 10 months during the storage.

★ BLUETOOTH PAGE AND COMPUTER APP PAGE

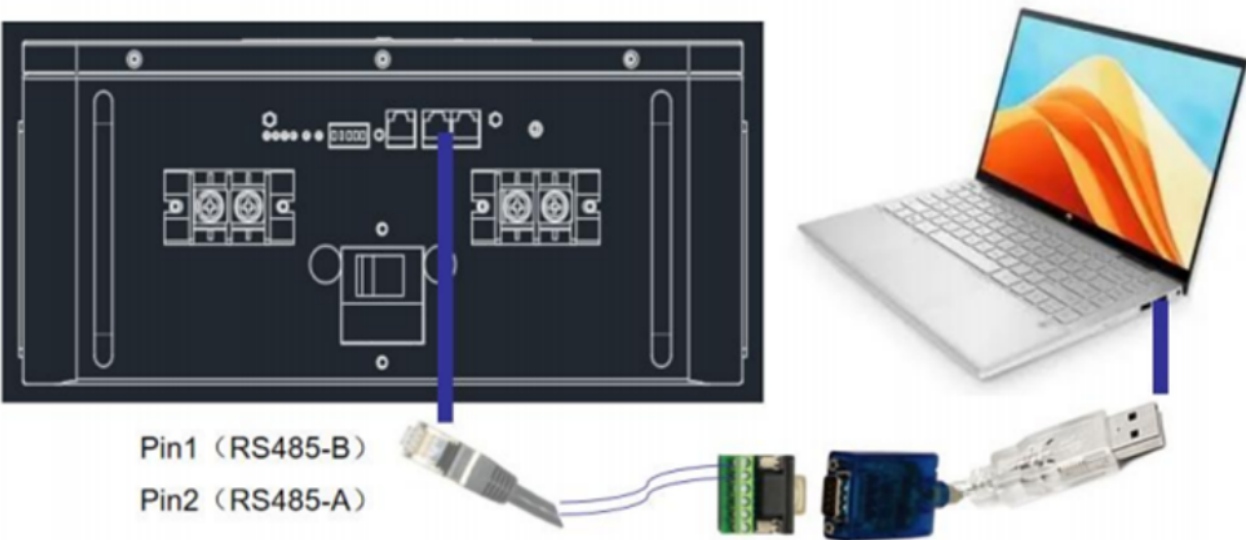

★ PERFORMANCE PARAMETER

Models	SW51B300TW2
Nominal Voltage (V)	51.2V
Nominal Capacity (AH)	314AH
Nominal Capacity (WH)	16076WH
Working Voltage (V)	43~57.6V
Max. Continuous Current(A)	150A
Max. Discharge Power(W)	8000W
Communication	RS485/CAN
Working Temperature	Charge:0°C~+55°C; Discharge:-10°C~+55°C
Modules Connection	1~15pcs in parallel
Screen Display	Yes
Bluetooth	Yes
Certification	CE/ EMC/ UN38.3/ MSDS
Design Life	10 years
Cycle Life	>6000@0.5C80%DOD
Dimension	820*660*239mm
Weight(Kg)	NG:120Kg Gross:140kg

Sunway Solar Co.,Ltd

E-mail:info@sunwaypv.com Tel:+86 138 6693 1144 www.sunwaypv.com  
Building 7, E-Commerce Supervision Zone, Huguang Road, Hefei, Anhui, China





★ PRODUCT SIZE

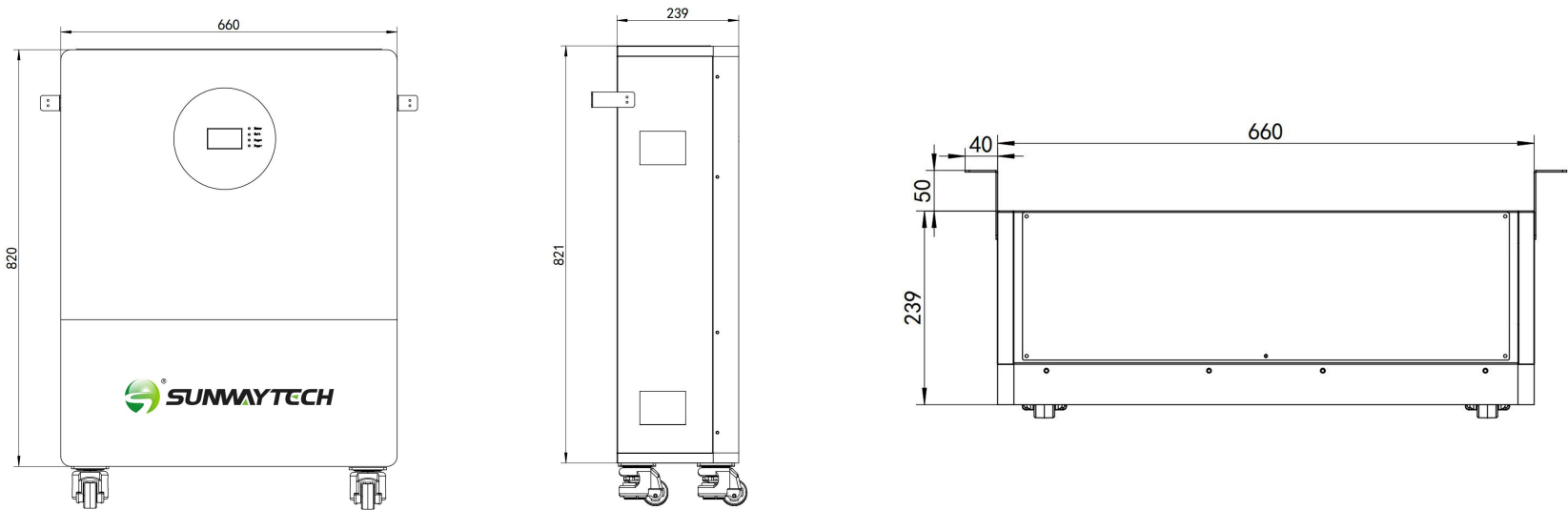

★ PRODUCT PACKAGING



★ PRODUCT DETAILS



★ FACTORY DISPLAY

