

SUNWAY WALL MOUNTED LITHIUM BATTERY

—25.6V 100AH



★ MAIN FEATURES

- The appearance size is greatly reduced
- Wall mounted/shelf installation available
- Added switch button
- The three-year warranty cannot be achieved for the plastic housing, we replaced it with sheet metal shell
- Support in parallel & series connection(Max 2s2p)
- The heat dissipation capacity of the product is greatly improved, and the whole battery supports 1C charge and discharge
- Low self discharge
- Built in protection for over-charge, over-discharge & over-temperature

★ PHOTOVOLTAIC ENERGY STORAGE DIAGRAM

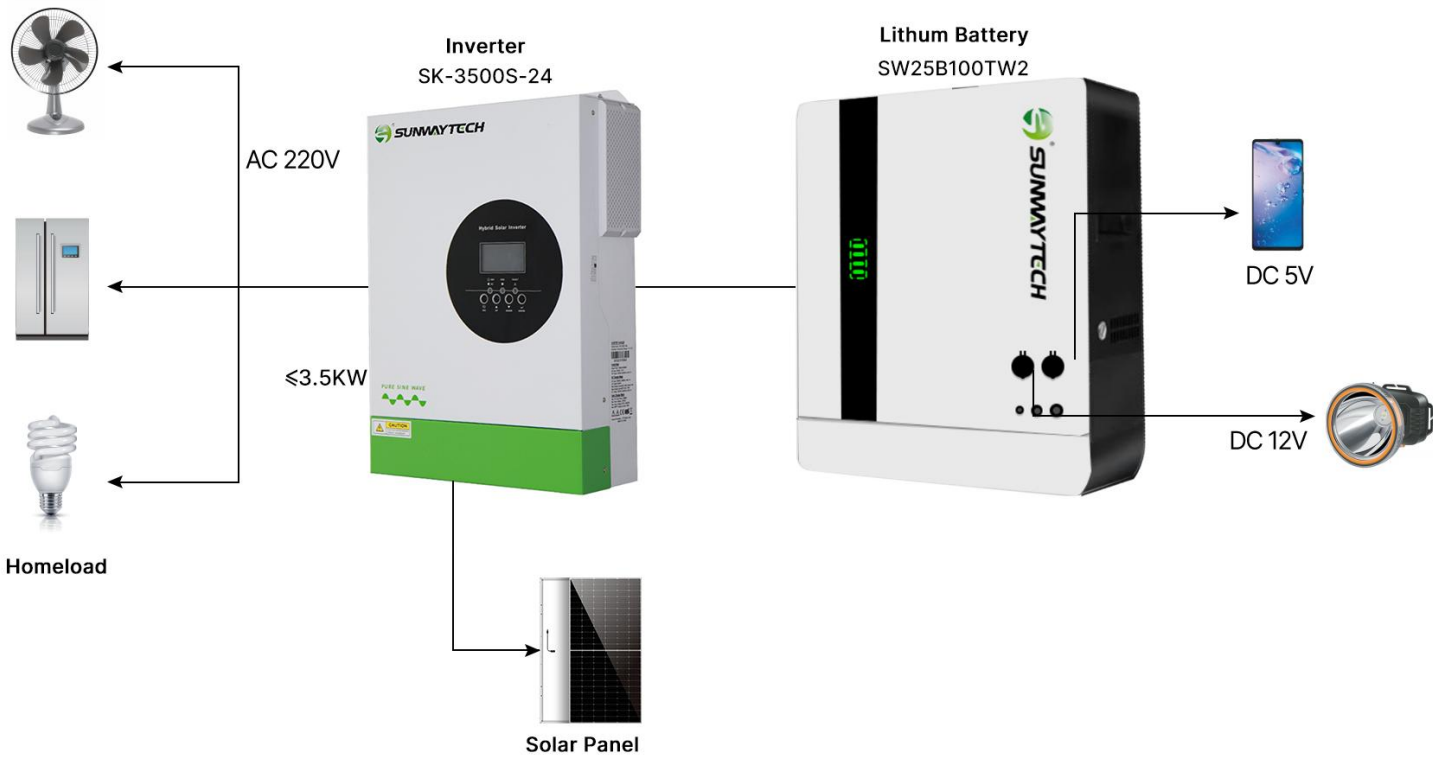

★ MAIN MODELS & TECHNICAL SPECIFICATION

Models	SW25B100TW2
Nominal Voltage (V)	25.6V
Nominal Capacity (AH)	100AH
Equalized Charge Voltage(V)	29.2V
Discharge Cut-off Voltage(V)	23V
Float Voltage (V)	27V
Bulk Voltage (V)	27.6~28.4V
Discharge Current Max Continuous (A)	100A
Pulse Current 5 Sec	120A
Weight	24.5+0.3kg
Dimensions L*W*H(mm)	442*440*143mm
Operation Temperature	-Charging:0°C to 50°C Discharging:-10°C to 50°C
Storage Temperature	-10~50°C
Relative Humidity(RH)	20-60(No Condensed Water)
Protection	IP33
Safety Certificate	CE,UN38.3,IEC,MSDS

★ CURVES

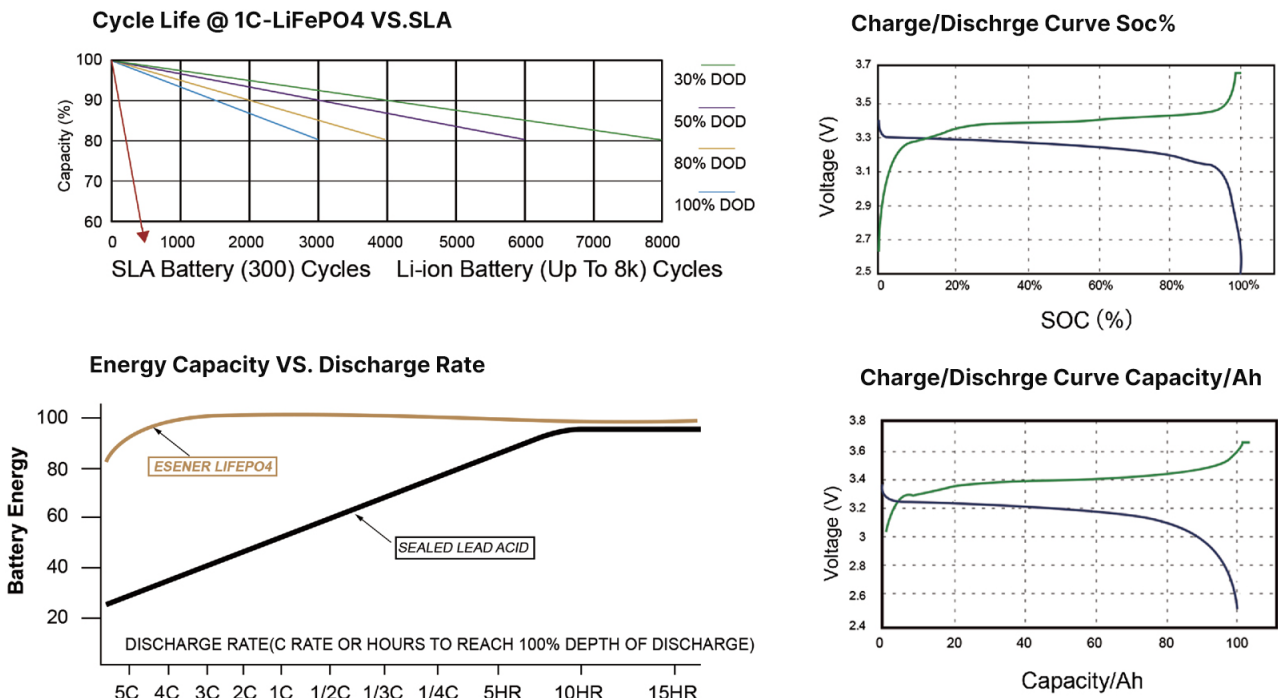

SUNWAY 3.5KW OFF GRID SOLAR INVERTER
—SK-3500S-24



★ MAIN FEATURES

- Pure sine wave solar inverter
- Output power factor 1
- High PV input voltage range
- Built-in MPPT solar controller
- Battery equalization function to optimize battery performance and extend lifecyc
- Inverter running without battery
- Built-in anti-dusk kit for harsh environment
- Support mutiple output priority:UTL,SOL,SBU,SUB
- Wifi/GPRS remote monitoring
- RS485 communication for BMS(Optional)
- Detachable LCD

★ PRODUCT DIMENSIONS AND SYSTEM CONNECTION DIAGRAM

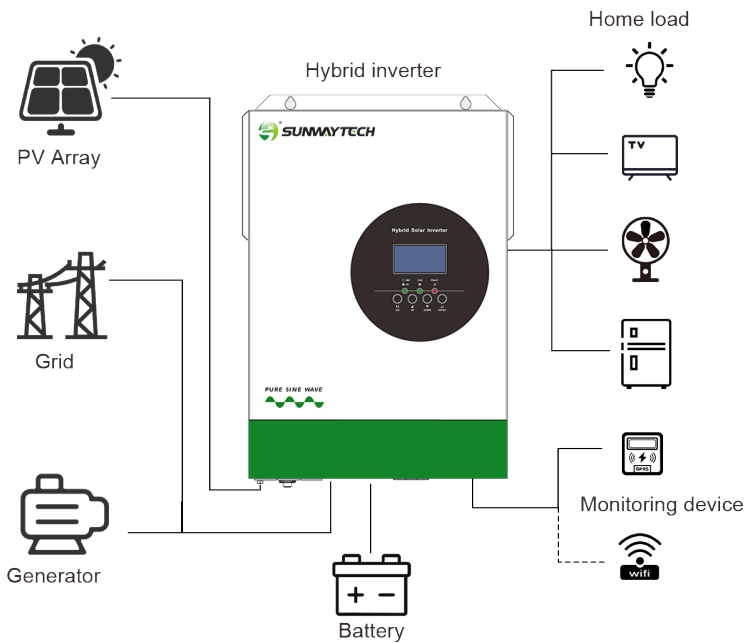
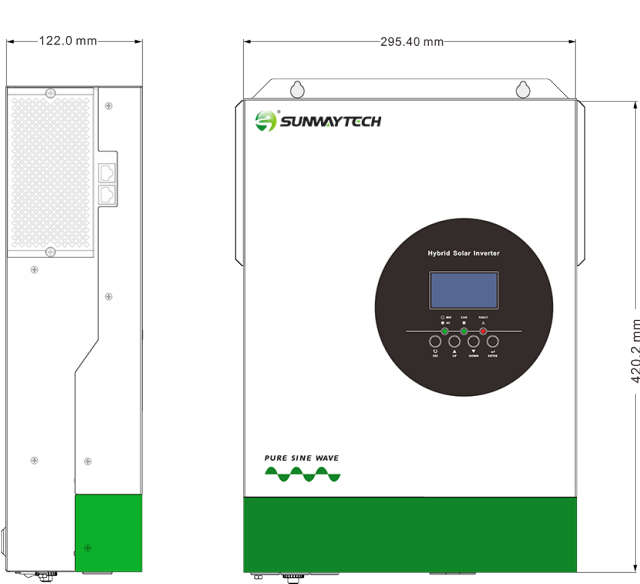

★ PRODUCT SPECIFICATIONS AND PARAMETERS

Model	SK-3500S-24
Capacity	3500VA/3500W
Battery type	Lead Acid
Parallel Capability	No
Input	
Nominal Voltage	230VAC
Acceptable Voltage Range	170-280VAC(For personal computer),90-280VAC(For home appliances)
Frequency	50Hz/60Hz(Auto sensing)
Output	
Nominal Voltage	220/230VAC±5%
Surge Power	7000VA
Frequency	50/60Hz
Wave Form	Pure sine wave
Transfer Time	10ms(For personal computer),20ms(For home appliances)
Peak Efficiency(PV to INV)	96%
Peak Efficiency(Battery to INV)	93%
Overload Protection	5s@≥150% load; 10@110%~150% load
Crest Factor	3:1
Admissiable Power Factor	0.6~1(inductive or capacitive)
Battery	
Battery Voltage	24VDC
Floating Charge Voltage	27VDC
Overcharge Protection	33VDC
Charge Method	CC/CV
Solar Charge & AC Charge	
Solar Charge Type	MPPT
Maximum PV Array Power	4000W
Maximum PV Array Open Circuit Vol.	500VDC
PV Array of MPPT Voltage Range	60VDC~500VDC
Maximum Solar Input Current	15A
Maximum Solar Charge Current	100A
Maximum AC Charge Current	80A
Maximum Charge Current	100A
Physical	
Product Dimension(D*W*H mm)	448*295*129mm
Package Size(D*W*H mm)	540*390*217mm
Net Weight(kgs)	9KG
Communication Interface	USB/Dry-contact
Environment	
Operation Temperature Range	-10℃~55℃
Storage Temperature	-15℃~50℃
Humidity	5% to 95% Relative Humidity(Non-condensing)